

*GRANDFATHERED BANK BRANCH ON PRIME UWS BROADWAY CORNER
WITH MORE THAN 150 FT OF FRONTAGE*

2260 BROADWAY

NORTHEAST CORNER OF WEST 81ST STREET & BROADWAY
UPPER WEST SIDE | MANHATTAN

2260 BROADWAY

PROPERTY HIGHLIGHTS

- Grandfathered bank branch for lease –
Currently Bank of America
- Over 150 feet of wraparound frontage along one of
the Upper West Side's most trafficked corridors



STEPS FROM
79th Street
SUBWAY STATION



\$252,419
AVERAGE HOUSEHOLD
INCOME
WITHIN 0.1 MILES



PROPERTY DETAILS

GROUND FLOOR:

5,000 SF

FRONTAGE:

52 FT on Broadway

99 FT on W. 81st St.

POSSESSION:

Arranged

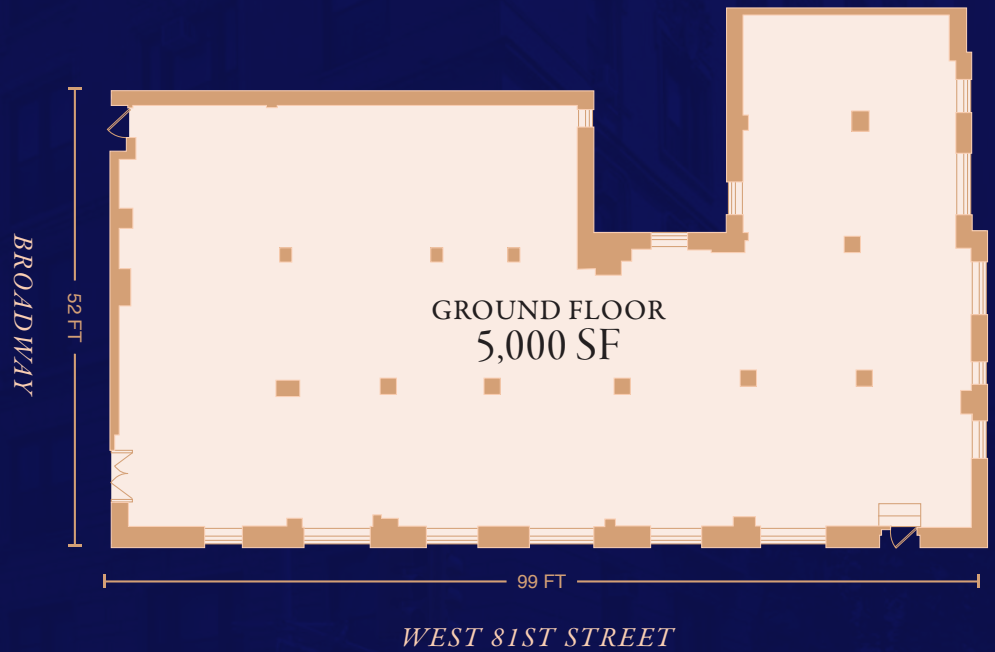

BROADWAY VIEW



WEST 81ST STREET VIEW



NOT TO SCALE. ALL DIMENSIONS AND CONDITIONS ARE APPROXIMATE AND FOR INFORMATION ONLY.

NEIGHBORHOOD

Neighboring retailers include:

WELLS FARGO (COMING SOON)

BARNES AND NOBLE

CLAIRE'S

NUTS FACTORY

ZABAR'S

CHASE BANK

STAPLES

STARBUCKS

FEDEX

SANTANDER BANK

TALBOTS



2260 BROADWAY

BRANDON L. SINGER

BRANDON@RETAILBYMONA.COM

516.808.6794

MANU WENDUM

MANU@RETAILBYMONA.COM

917.331.6238

THIS INFORMATION HAS BEEN OBTAINED FROM SOURCES BELIEVED RELIABLE, BUT HAS NOT BEEN VERIFIED FOR ACCURACY OR COMPLETENESS. YOU SHOULD CONDUCT A CAREFUL, INDEPENDENT INVESTIGATION OF THE PROPERTY AND VERIFY ALL INFORMATION. ANY RELIANCE ON THIS INFORMATION IS SOLELY AT YOUR OWN RISK. MONA AND THE MONA LOGO ARE SERVICE MARKS OF MONA RETAIL HOLDINGS LLC. ALL OTHER MARKS DISPLAYED ON THIS DOCUMENT ARE THE PROPERTY OF THEIR RESPECTIVE OWNERS, AND THE USE OF SUCH LOGOS DOES NOT IMPLY ANY AFFILIATION WITH OR ENDORSEMENT OF MONA RETAIL HOLDINGS LLC.

mona