



# FLOOR PLANS

148 EAST 28TH STREET

## GROUND FLOOR

550 SF

## BACKYARD

2,000 SF

## FRONTAGE

15 FT ON EAST 28TH STREET

## POSSESSION

APRIL 1ST, 2024

## HIGHLIGHTS

- Move-in ready retail in Murray Hill.
- Large backyard.
- Restroom in place.
- All non-vented uses considered.
- Close proximity to Baruch College.
- Over 1,200 residential units within a 1-block radius.
- Tremendous foot traffic along 3rd Avenue.

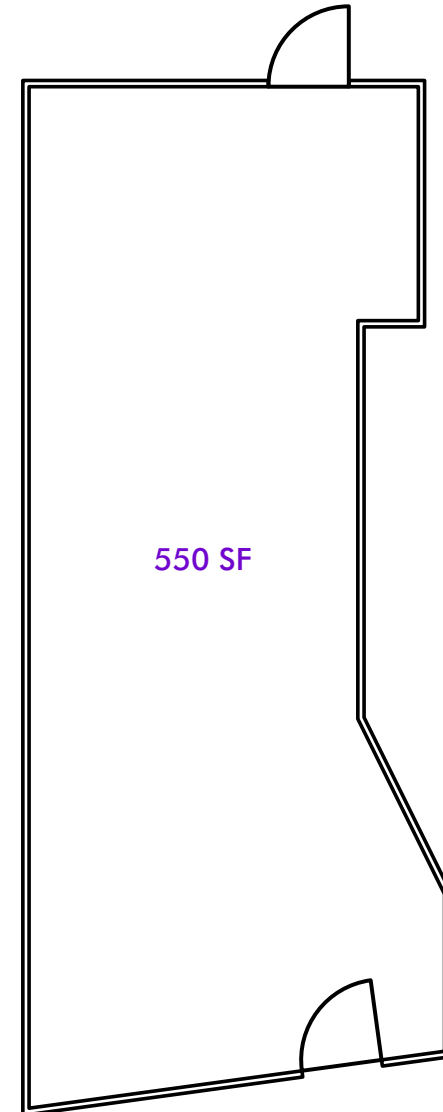

**mona**

**JOHN DIGANGI**

JOHN@RETAILBYMONA.COM  
516 776 0664

# MAP

## SELECT NEARBY RETAIL TENANTS

- STARBUCKS
- 7-ELEVEN
- KALUSTYAN'S
- TRADER JOE'S
- DUNKIN DONUTS
- TARA ROSE
- COLETTA
- THE GEM SALOON
- 7TH STREET BURGER
- STREET TACO
- VERIZON
- PETOPIA
- DOMINO PIZZA
- MATTRESS FIRM
- BANTER
- LITTLE RUBY'S
- CRAFT + CARRY BIRCH COFFEE
- VAN LEEUWEN
- MEZE MAZI
- BOND VET
- DAN & HON'S WINGS
- BANC CAFE
- BAREBURGER
- 16 HANDLES
- TASTI-D-LITE
- SIMON HARDWARE & BATH
- FUMO
- BELLA UNION

## 148 EAST 28TH STREET



This information has been obtained from sources believed reliable, but has not been verified for accuracy or completeness. You should conduct a careful, independent investigation of the property and verify all information. Any reliance on this information is solely at your own risk. MONA and the MONA logo are service marks of Mona Retail Holdings LLC. All other marks displayed on this document are the property of their respective owners, and the use of such logos does not imply any affiliation with or endorsement of Mona Retail Holdings LLC.

**mona**

**JOHN DIGANGI**

JOHN@RETAILBYMONA.COM  
516 776 0664