

285 MADISON AVENUE

GRAND CENTRAL, MANHATTAN
BETWEEN EAST 40TH & EAST 41ST STREETS

JOIN QSR HEAVYWEIGHTS NAYA & PANERA ON ONE OF
MIDTOWN'S BUSIEST CORRIDORS

mona



FLOOR PLANS

285 MADISON AVENUE

GROUND FLOOR

1,728 SF + STORAGE MEZZANINE

FRONTAGE

13 FT ON MADISON AVENUE

CEILING HEIGHT

GROUND FLOOR: 21 FT

POSSESSION

IMMEDIATE

AS-BUILT CONSTRUCTION
PLANS AVAILABLE.

GROUND FLOOR

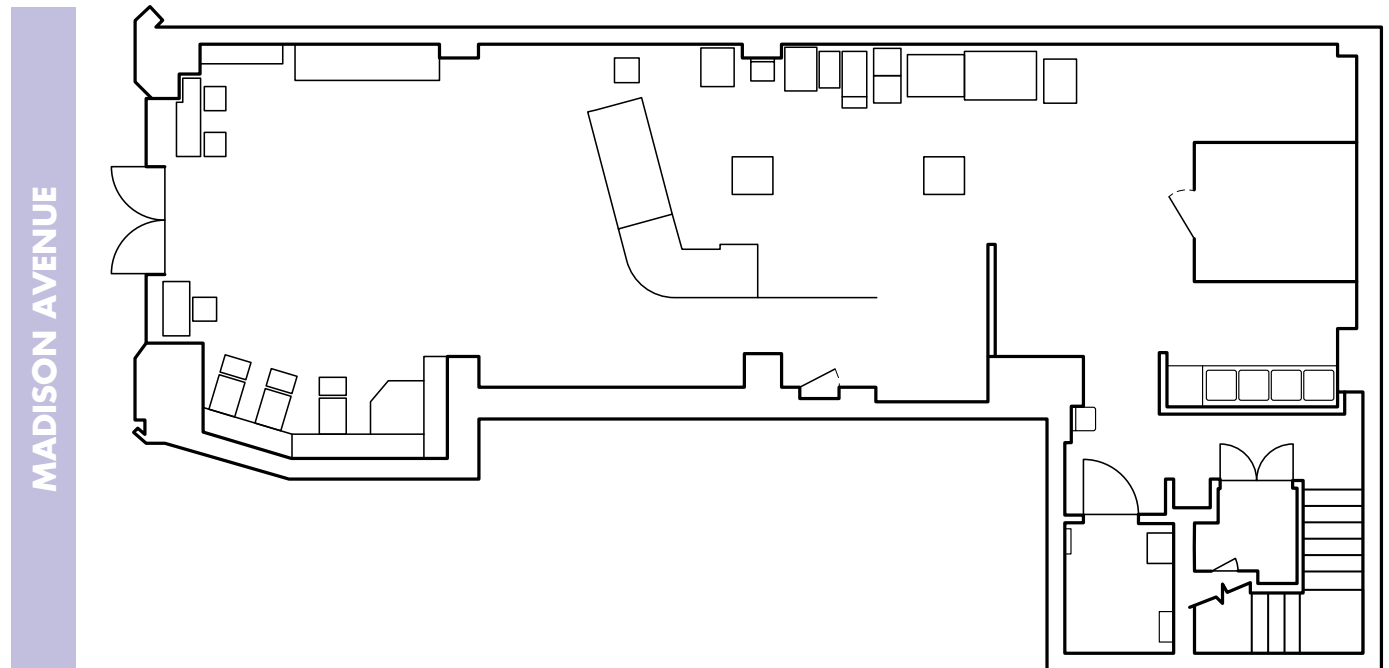

mona

BRANDON SINGER

BRANDON@RETAILBYMONA.COM

SUZANNE BERNSTOCK

SUZANNE@RETAILBYMONA.COM
(610) 903-2207

MARISA SIMKIN

MARISA@RETAILBYMONA.COM
(408) 482-0064

HIGHLIGHTS

285 MADISON AVENUE

- Previously Dos Toros.
- Second generation vented QSR.
- Steps from Grand Central & Bryant Park – servicing over 70 million commuters.
- At the base of a 26 story, 530,000 SF office building with notable tenants, including Tommy Hilfiger, General Electric, and Brighthouse Financial.
- All uses considered.



mona

BRANDON SINGER

BRANDON@RETAILBYMONA.COM

SUZANNE BERNSTOCK

SUZANNE@RETAILBYMONA.COM
(610) 903-2207

MARISA SIMKIN

MARISA@RETAILBYMONA.COM
(408) 482-0064

MAP

285 MADISON AVENUE

NEARBY PUBLIC TRANSIT:

B,D,F,M,7 @ BRYANT PARK

4,5,6,7,S @ GRAND CENTRAL

NEIGHBORING RETAIL TENANTS

- NAYA
- PANERA
- SUMMER SALT
- LIBRARY HOTEL
- CAVA
- CHICK FIL A
- ANDAZ HOTEL
- GREGORY'S COFFEE
- WHOLE FOODS
- BLUE BOTTLE
- LOS TACOS NO. 1
- STARBUCKS
- FEDEX
- ZARA
- MUJI

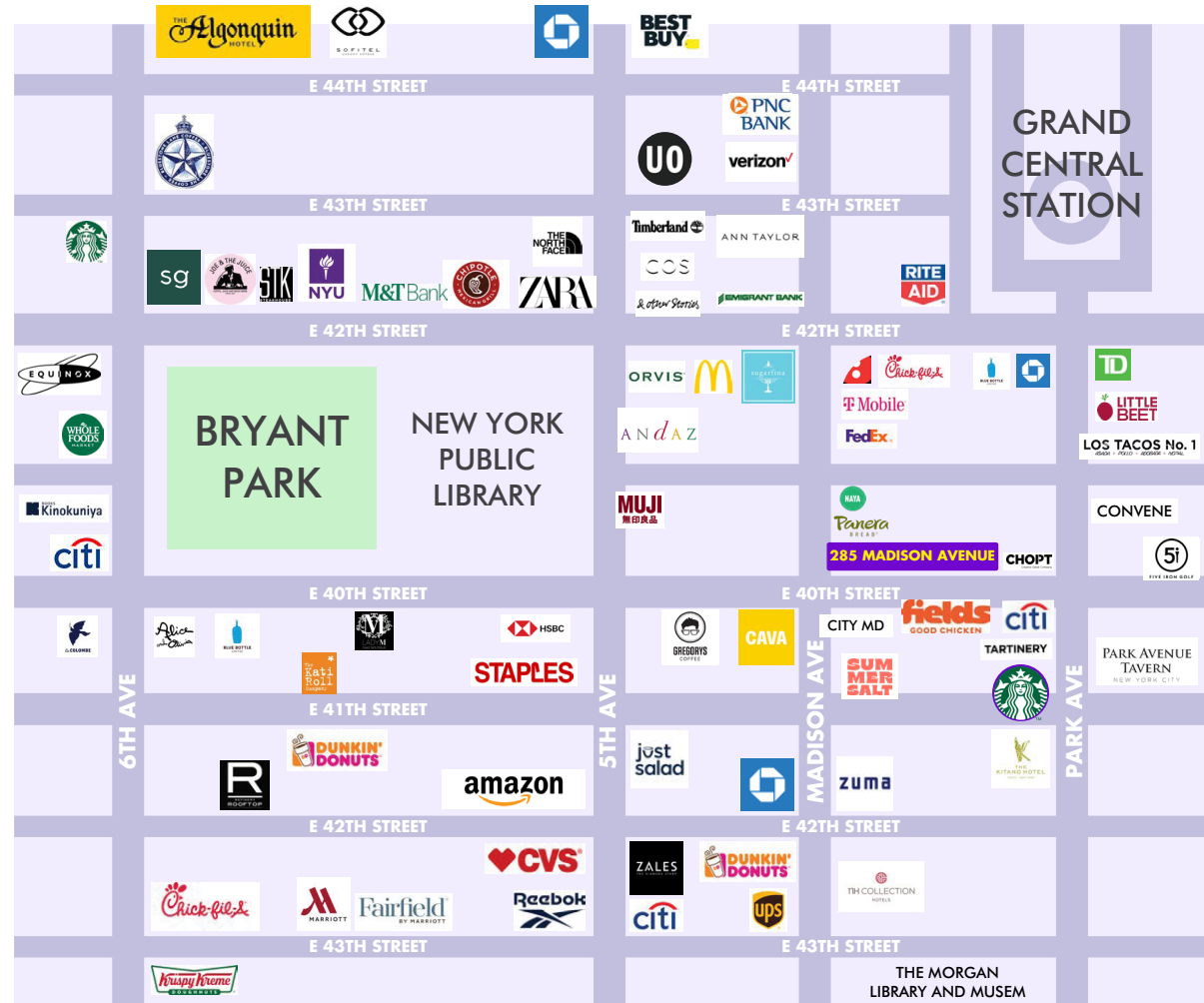

This information has been obtained from sources believed reliable, but has not been verified for accuracy or completeness. You should conduct a careful, independent investigation of the property and verify all information. Any reliance on this information is solely at your own risk. MONA and the MONA logo are service marks of Mona Retail Holdings LLC. All other marks displayed on this document are the property of their respective owners, and the use of such logos does not imply any affiliation with or endorsement of Mona Retail Holdings LLC.



BRANDON SINGER

BRANDON@RETAILBYMONA.COM

SUZANNE BERNSTOCK

SUZANNE@RETAILBYMONA.COM
(610) 903-2207

MARISA SIMKIN

MARISA@RETAILBYMONA.COM
(408) 482-0064