

# 2030

## BROADWAY

70TH STREET BETWEEN BROADWAY & COLUMBUS AVENUE  
UPPER WEST SIDE, MANHATTAN

LOWER LEVEL  
OPPORTUNITY



mona



# FLOOR PLAN

2030 BROADWAY

## LOWER LEVEL

2,828 SF

## CEILING HEIGHT

9 FT

## POSSESSION

Immediate

- Unique Lower Level retail space located on the Upper West Side.
- Positioned on dense residential block at the base of a full amenity apartment building.
- Neighboring many popular restaurants and destination retailers.
- Access to commercial lobby and elevator.
- Opportunity for signage and visibility on Broadway.
- Open to all uses.

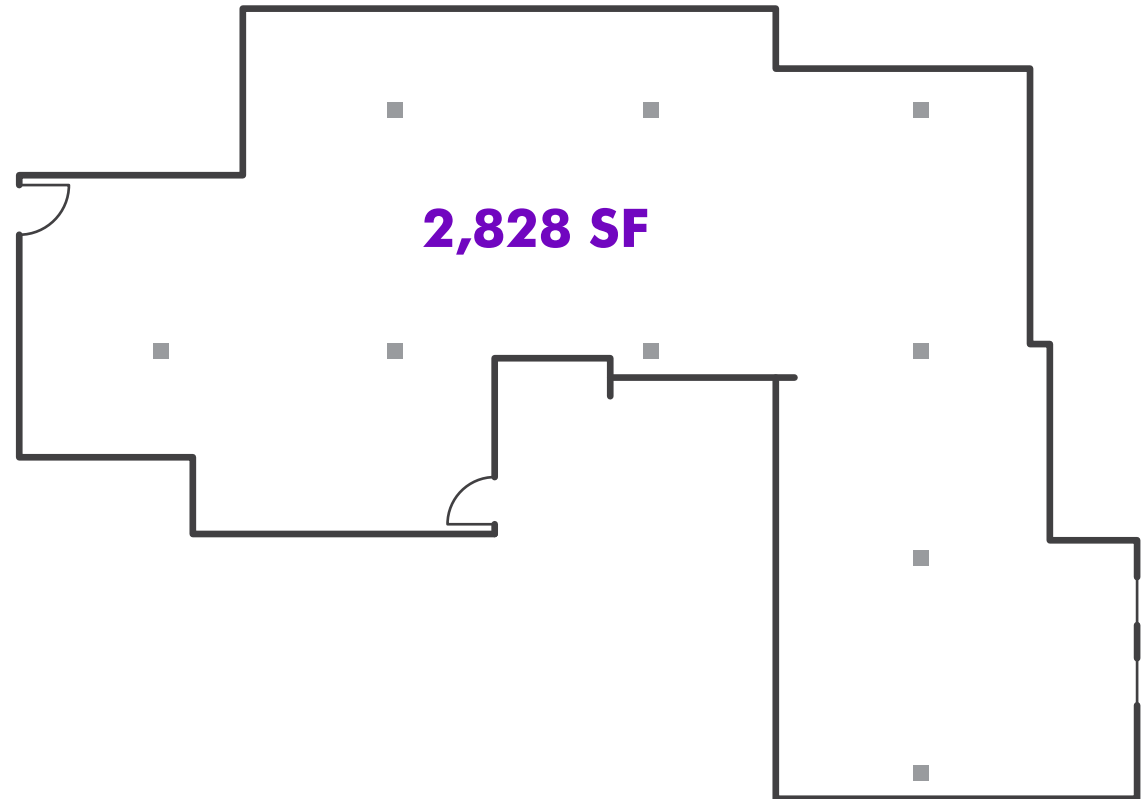

mona

**BRANDON SINGER**

BRANDON@RETAILBYMONA.COM

**MANU WENDUM**

MANU@RETAILBYMONA.COM  
917-331-6238

**LAUREN FARNOOSH**

LAUREN@RETAILBYMONA.COM  
559-974-1227

# MAP

# 2030 BROADWAY

NEARBY PUBLIC TRANSIT:

**1, 2, 3, C, B**

SELECT NEARBY RETAIL TENANTS:

- Trader Joes
- Bank of America
- Just Salad
- Madewell
- Lululemon
- Aesop
- Theory
- Apple
- Core Power Yoga
- Wonder
- CityMD Urgent Care
- Q Ten Nail Spa
- Barry's
- CrossFit NYC
- R and L Nail Spa
- The Yoga Trail

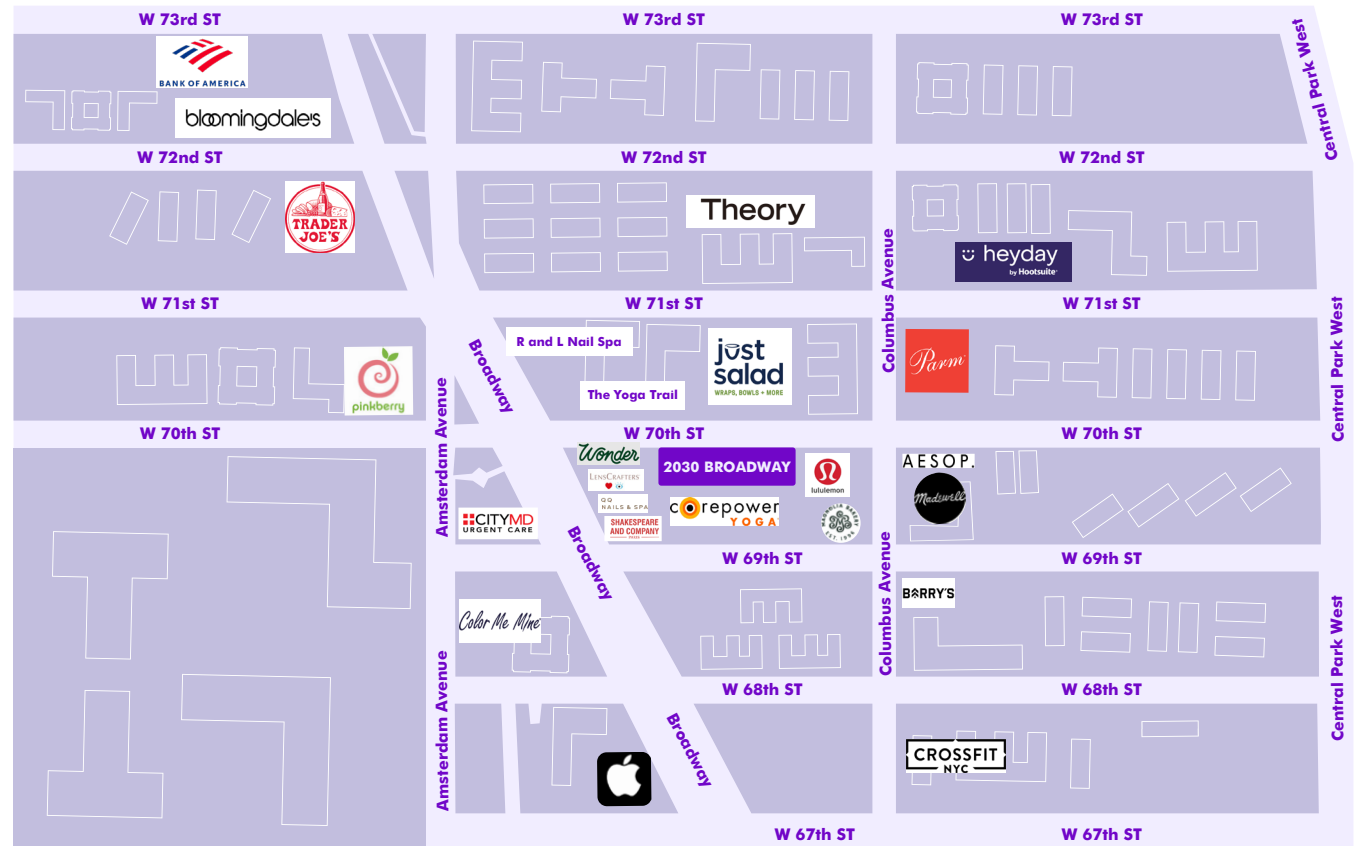

**BRANDON SINGER**

BRANDON@RETAILBYMONA.COM

**MANU WENDUM**

MANU@RETAILBYMONA.COM  
917-331-6238

**LAUREN FARNOOSH**

LAUREN@RETAILBYMONA.COM  
559-974-1227



**BRANDON SINGER**

BRANDON@RETAILBYMONA.COM

**MANU WENDUM**

MANU@RETAILBYMONA.COM

917-331-6238

**LAUREN FARNOOSH**

LAUREN@RETAILBYMONA.COM

559-974-1227

**mona**