

401

W 14TH STREET

BETWEEN 9TH & 10TH AVENUES

MEATPACKING | MANHATTAN



moma

PRIME 14TH STREET RETAIL ADJACENT TO APPLE

401
W 14TH STREET
BETWEEN 9TH & 10TH
AVENUES



BRANDON SINGER
brandon@retailbymona.com
516 808 6794

MATTHEW BALL
matthew@retailbymona.com
516 946 2523

MAX KREINCES
max@retailbymona.com
631 827 8899

mona

FLOOR PLANS

GROUND FLOOR
4,237 SF

LOWER LEVEL
926 SF

CEILING HEIGHTS
Ground Floor: 15 FT
Lower Level: TBD

FRONTAGE
25 FT on 14th Street

POSSESSION
Immediate

401
W 14TH STREET
BETWEEN 9TH & 10TH
AVENUES

GROUND FLOOR

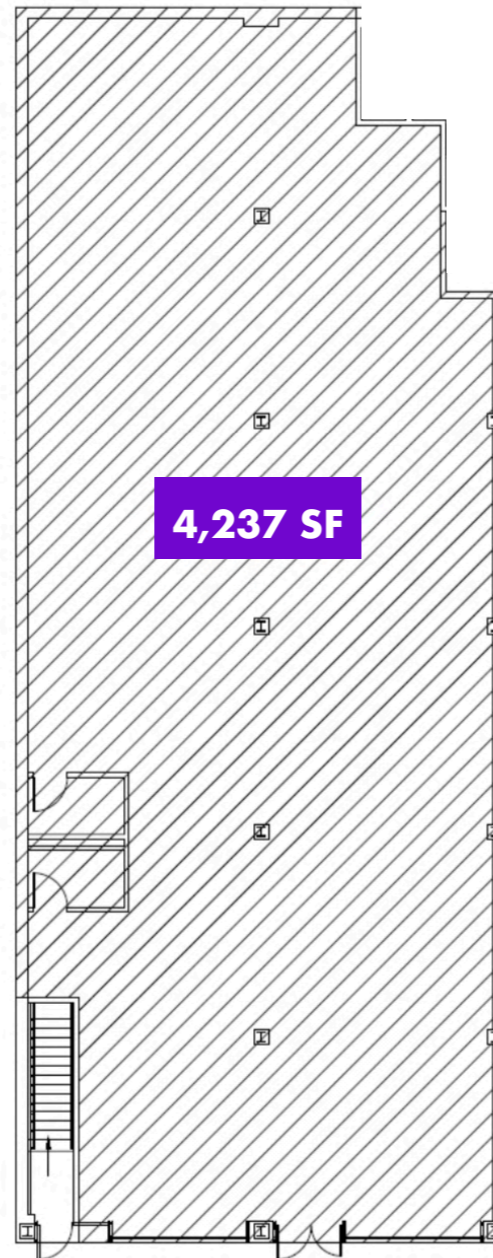

LOWER LEVEL

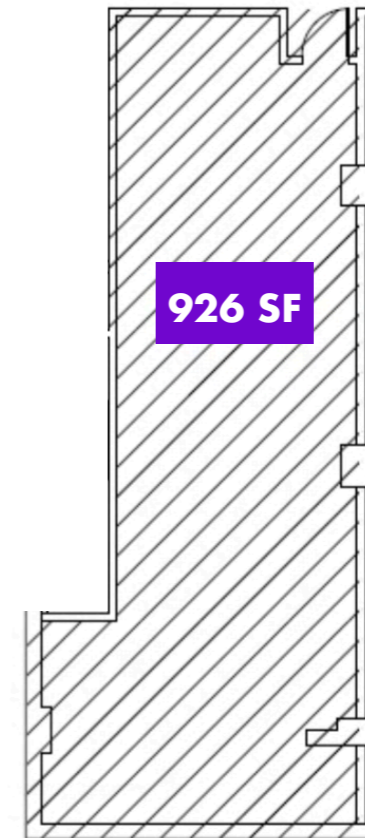

← **14TH STREET** →

Not to scale. All dimensions and conditions are approximate and for information only.

BRANDON SINGER
brandon@retailbymona.com
516 808 6794

MATTHEW BALL
matthew@retailbymona.com
516 946 2523

MAX KREINCES
max@retailbymona.com
631 827 8899

mona

HIGHLIGHTS

Formerly Soho Home Studio in Meatpacking District.

Ideally situated on prime 14th Street adjacent to Apple.

Situated near the Gucci and Breitling downtown flagships that are slated to open in Q1 of 2023.

Located in prime tourist destination one block from Chelsea Market, which brings in 9 million visitors per year.

Exposed brick wall throughout space.

Storage lower level.

401
W 14TH STREET
BETWEEN 9TH & 10TH
AVENUES



BRANDON SINGER
brandon@retailbymona.com
516 808 6794

MATTHEW BALL
matthew@retailbymona.com
516 946 2523

MAX KREINCES
max@retailbymona.com
631 827 8899

mona

MAP

NEARBY PUBLIC TRANSIT

A C E L F M 1 2 3 & PATH

SELECT NEARBY
RETAIL TENANTS

- Gucci**
- Breitling**
- Patagonia**
- Apple**
- Samsung**
- Rolex**
- Sephora**
- Serafina**
- Lladro**
- Intimissimi**
- Yext HQ**
- Google HQ**
- Catch**
- Lucid**
- Chelsea Market**
- Starbucks Reserve**
- Gansevoort Hotel**
- RH Rooftop**
- RH Guesthouse**
- Soho House**

401
W 14TH STREET
BETWEEN 9TH & 10TH
AVENUES



BRANDON SINGER
brandon@retailbymona.com
516 808 6794

MATTHEW BALL
matthew@retailbymona.com
516 946 2523

MAX KREINCES
max@retailbymona.com
631 827 8899



BRANDON SINGER

CEO + FOUNDER

brandon@retailbymona.com

516 808 6794

MATTHEW BALL

matthew@retailbymona.com

516 946 2523

MAX KREINCES

max@retailbymona.com

631 827 8899



@RETAILBYMONA



RETAIL-BY-MONA

RETAILBYMONA.COM

mona

TACONIC
PARTNERS