

# THE RETAIL AT **PARAMOUNT TIMES SQUARE**

235 WEST 46TH STREET

BETWEEN SEVENTH AVENUE & EIGHTH AVENUE  
TIMES SQUARE, MANHATTAN



**mona**  
EXCLUSIVE RETAIL LEASING AGENT

RENDERED IMAGE



**PARAMOUNT TIMES SQUARE**

235 W 46TH STREET

# SEEKING DRY USE TENANTS FOR A RETAIL OPPORTUNITY IN THE HEART OF THE THEATER DISTRICT.



**mona**

**BRANDON SINGER**

BRANDON@RETAILBYMONA.COM  
888-421-6662

**MICHAEL CODY**

MICHAEL@RETAILBYMONA.COM  
513-374-8630

# OVERVIEW

## PARAMOUNT TIMES SQUARE

235 W 46TH STREET

### GROUND FLOOR

2,775 SF

### CEILING HEIGHT

11 FT 5 IN

### FRONTAGE

30 FT on West 46th Street

### POSSESSION

Arranged

### HIGHLIGHTS

- At the base of Paramount Times Square, a 500+ room hotel operated by Generator.
- The available retail space is adjacent to Sony Hall, an iconic music venue with a 1,000 guest capacity.
- Same block as the Richard Rodgers Theatre, home to Broadway sensation *Hamilton*.

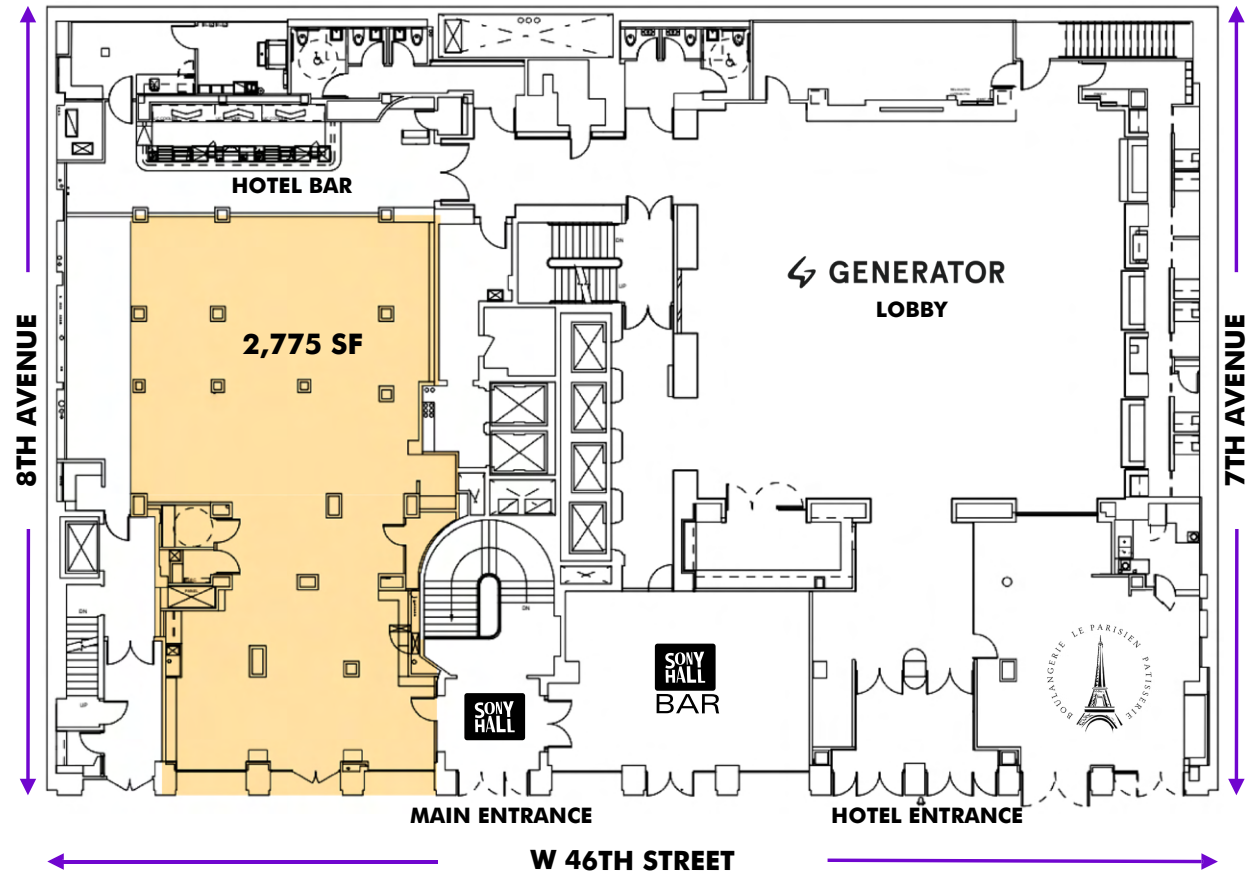

mona

BRANDON SINGER

BRANDON@RETAILBYMONA.COM  
888-421-6662

MICHAEL CODY

MICHAEL@RETAILBYMONA.COM  
513-374-8630

# MAP

## PARAMOUNT TIMES SQUARE

235 W 46TH STREET

### NEARBY PUBLIC TRANSIT

**N R W** 49th St

**B D F M** 47th-50th St - Rockefeller Center

### NEARBY CO-TENANTS

- Sony Hall
- Richard Rodgers Theatre
- Patis Bakery
- Dunkin'
- American Eagle
- Dos Caminos
- Swarovski
- Bond 45 NY
- W New York
- Living Room
- The Edison Ballroom
- Imperial Theatre
- Shubert Theatre
- Golden Theatre
- Bernard B. Jacobs Theatre
- Majestic Theatre

This information has been obtained from sources believed reliable, but has not been verified for accuracy or completeness. You should conduct a careful, independent investigation of the property and verify all information. Any reliance on this information is solely at your own risk. MONA and the MONA logo are service marks of Mona Retail Holdings LLC. All other marks displayed on this document are the property of their respective owners, and the use of such logos does not imply any affiliation with or endorsement of Mona Retail Holdings LLC.

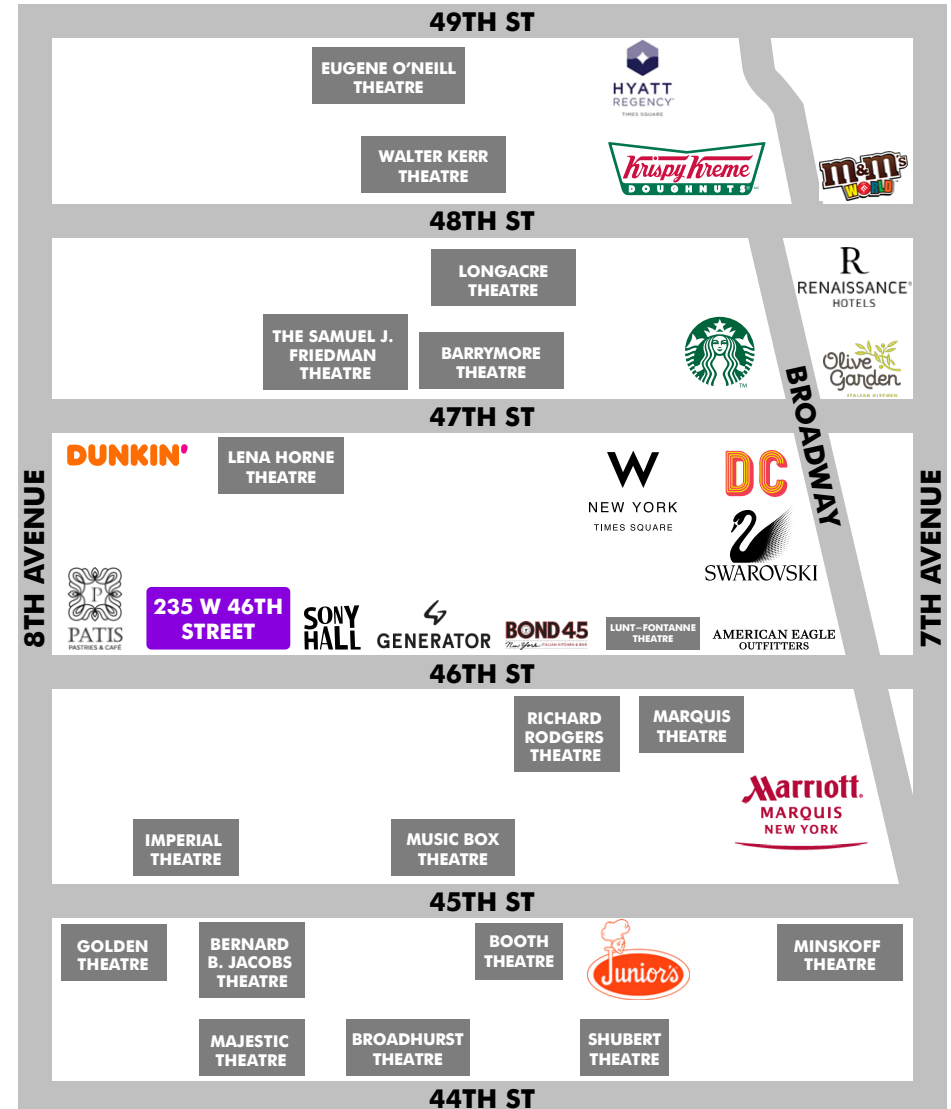

# mona

**BRANDON SINGER**

BRANDON@RETAILBYMONA.COM  
888-421-6662

**MICHAEL CODY**

MICHAEL@RETAILBYMONA.COM  
513-374-8630