

THE RETAIL AT  
**PARAMOUNT HOTEL**  
235 W 46<sup>TH</sup> STREET

THEATER DISTRICT  
MANHATTAN



menga



# LOCATED IN THE HEART OF THE THEATER DISTRICT

PARAMOUNT HOTEL  
235 WEST 46<sup>TH</sup> STREET



# SEEKING DRY USE TENANTS

BRANDON SINGER  
brandon@retailbymona.com  
516 808 6794

KIM LEVANDOVSKY  
kim@retailbymona.com  
347 431 5354

SUNNY WOO  
sunny@retailbymona.com  
646 295 0348

mona



# FLOOR PLANS

**GROUND FLOOR**  
2,775 SF

**CEILING HEIGHTS**  
11' 5"

**FRONTAGE**  
30'

**POSSESSION**  
Arranged

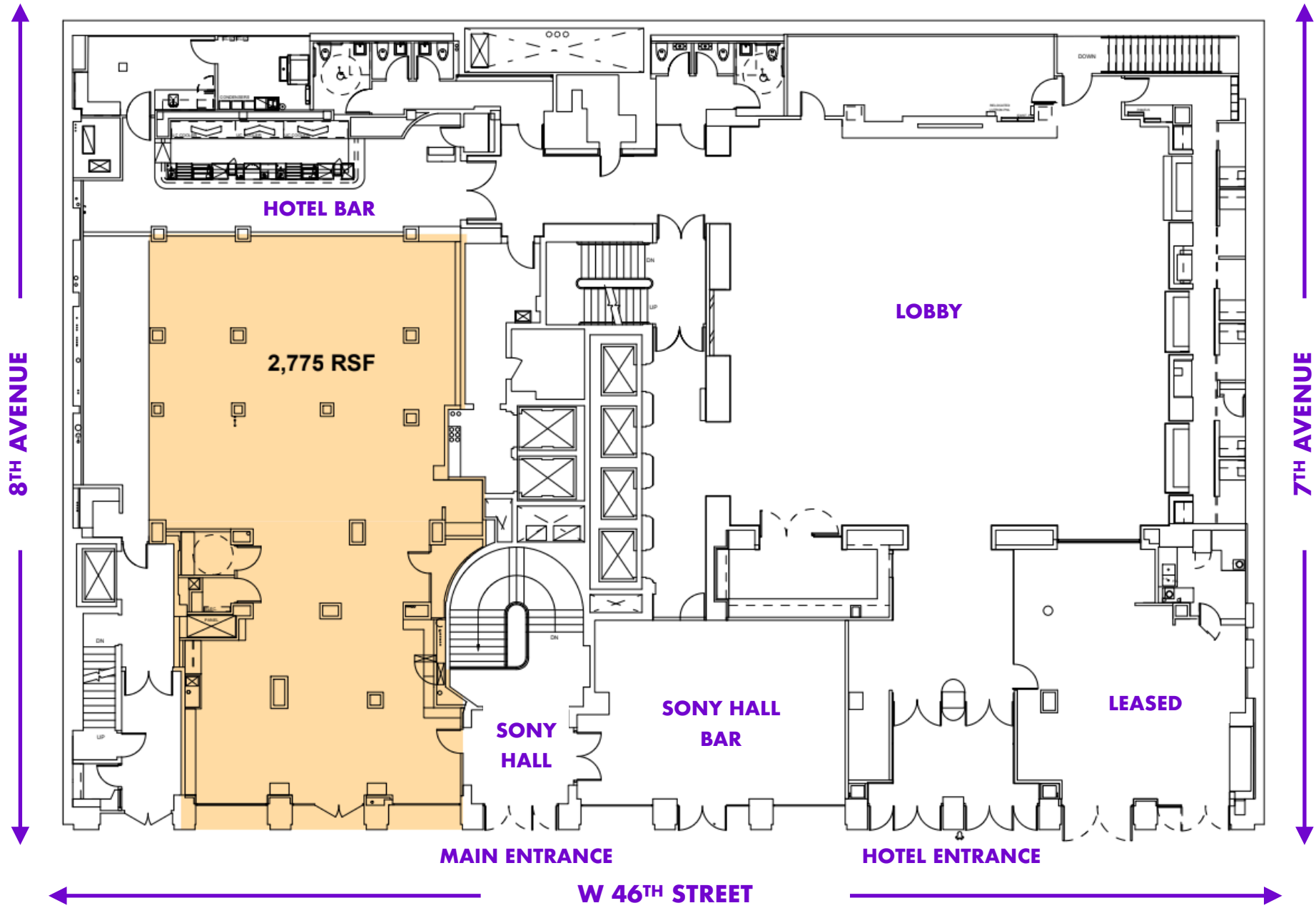

Not to scale. All dimensions and conditions are approximate and for information only.

BRANDON SINGER  
brandon@retailbymona.com  
516 808 6794

KIM LEVANDOVSKY  
kim@retailbymona.com  
347 431 5354

SUNNY WOO  
sunny@retailbymona.com  
646 295 0348



## HIGHLIGHTS

Currently the Hamilton Gift Shop. Located adjacent to the famous Sony Hall.

Situated at the base of the iconic landmarked Paramount Hotel in the heart of the Theater District containing 605 hotel rooms.

The Paramount Hotel is located on the same block as the Richard Rodgers Theatre, home of Hamilton.



BRANDON SINGER  
brandon@retailbymona.com  
516 808 6794

KIM LEVANDOVSKY  
kim@retailbymona.com  
347 431 5354

SUNNY WOO  
sunny@retailbymona.com  
646 295 0348



# MAP

NEARBY PUBLIC TRANSIT

**N R W** - 49<sup>TH</sup> Street

**B D F M** - 47-50 Streets -  
Rockefeller Center

SELECT NEARBY  
RETAIL TENANTS



- Sony Hall
- Richard Rodgers Theatre
- Patis Bakery
- Dunkin'
- American Eagle
- Dos Caminos
- Swarovski
- Bond 45 NY
- W New York
- Living Room
- The Edison Ballroom
- Imperial Theater
- Shubert Theatres
- Golden Theatre
- Bernard B. Jacobs Theatre
- Majestic Theatre



**PARAMOUNT HOTEL**  
235 WEST 46<sup>TH</sup> STREET



**EXPRESS**

**FOREVER 21**



BRANDON SINGER  
brandon@retailbymona.com  
516 808 6794

KIM LEVANDOVSKY  
kim@retailbymona.com  
347 431 5354

SUNNY WOO  
sunny@retailbymona.com  
646 295 0348

